

Scotsman®

INTRODUCING THE **NU & NW** RANGE



THE NEW EASY **S** LINE

EAS^Y: the new dice range

Scotsman
Ice Systems

The most popular and consumed ice type in the world – using the well recognised vertical evaporator system – has always been available in the Scotsman product offering.

Levering on market requests of having a simple no frills DICE vertical evaporator ice machine, today we have developed a new undercounter and modular series: the new EAS^Y NU and NW range.





The most popular ice type.

All the ice makers in this series feature the classic six faces ice cube: its large contact surface grants a quick cooling of all beverages and its cube shape adapts very well to any shape of glass.

Available different size cubes:

- Half Cube, 6 grams (NU & NW)
- Medium Cube, 10 grams (NU)
- Full Cube, 12 grams (NW)



NU
100

50 kg

NU
150

75 kg

NU
220

100 kg

NU
300

150 kg

MEDIUM PRODUCTION



NW
458

200 kg

NW
608

300 kg

NW
1008

500 kg

HIGH PRODUCTION

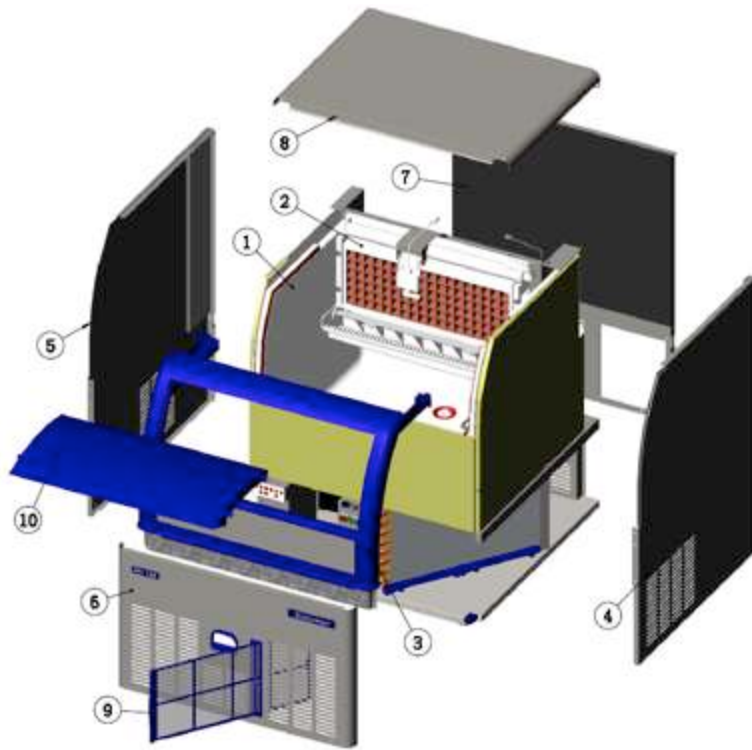

NU
Range

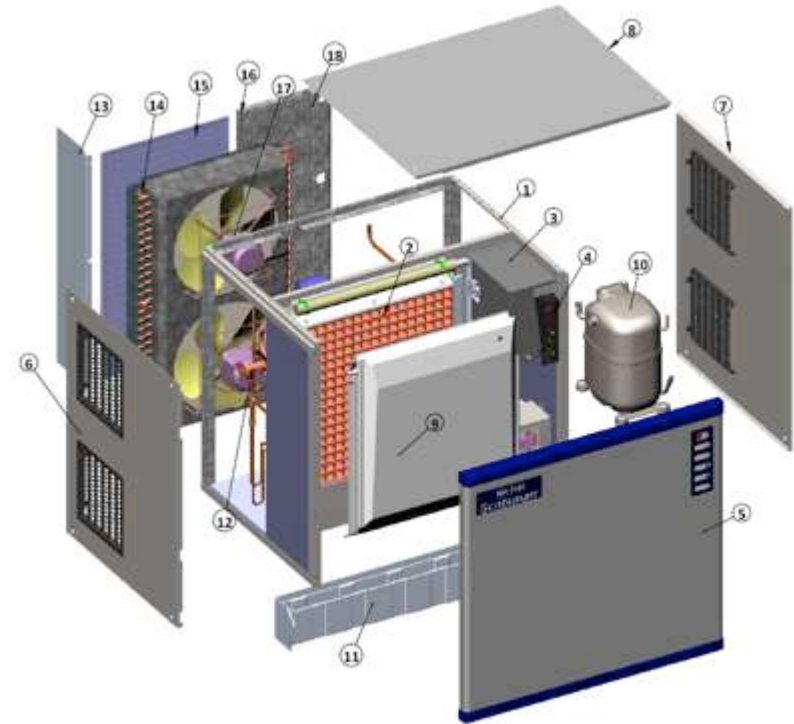

NW
Range

EA **S**Y dependability

*Resistant stainless steel
Injection moulding construction
Advanced electronic controls*



EA **S**Y serviceability

*Easy accessibility
Front access extractable filter
Routine maintenance*

EA **S**Y friendly

*On/off switch front push-button
Hygienic scoop holder
Suitable for all undercounter installations*



High grade stainless steel

NU series ice makers are built with high grade resistant stainless steel frames and side panels, for rust-free durability, easy of cleaning and the best hygiene.

Injection moulding interior

Rotocast made interior with injection moulding as to have a very high reliable product.

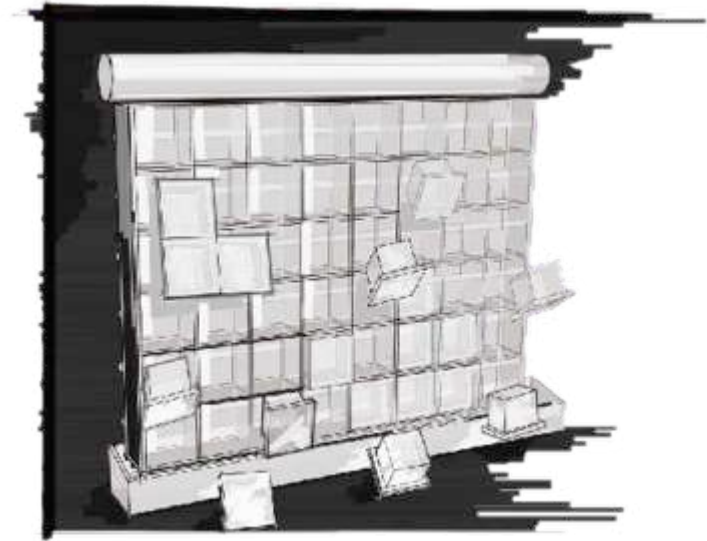

Electronic controls

Advanced electric controls, front ON-OFF switch, routine maintenance alarms and advanced PC board with indicator lights to simplify maintenance manpower and save time.



Front access maintenance

Repositioned evaporator for easier and more friendly cleaning operations.

Front access filter

The air filter is positioned directly in front of the condenser (air cooled model only), thus preventing the build up of dust and it is easily removable and washable.



Easy cleaning

Front ON-OFF switch, routine maintenance alarms and advanced PC board to simplify maintenance



ON-OFF switch front button

Easy front panel indicator and controls.
Visible routine maintenance.
Alarm light on front panel.

Hygienic scoop holder

The ice scoop is located in a specially designed holder just inside the storage bin, in order to facilitate and safeguard hygienic conditions.

Built-in installation

Suitable for all undercounter installations.
Reduced footprint makes NU models suitable for under-counter installations with 770 mm in height.
Front panel condenser airflow is a standard feature on most of Scotsman models thus allowing built-in installation even in very restricted spaces.



EA **S**Y accessibility

Injection moulding construction
Advanced electronic controls
Double stacking installations
Global standard footprint



EA **S**Y serviceability

Resistant stainless steel
Auto alert indicators
Routine maintenance
One touch cleaning



Advanced electronic controls

External indicator lights provide information resulting in early alert and fast diagnosis of operating issues

Global standard footprint

Footprint of 22 (future) and 30 inches. Strictly follows international imperial standard commonly adopted in the industry.

Double stack installations

The NW models can be double-stacked in necessity of very high ice demands, thus saving space and doubling the output at the same time.

Stainless steel panels

NW series ice makers are built with stainless steel frames and side panels, for rust-free durability, easy of cleaning and the best hygiene..





Proximity condenser filter

The NW proximity air filter is mounted next to the condenser, for best air filtration results.

Easy to clean and reusable, it effectively protects the condenser from dust and grease, thus increasing ice making efficiency.

Auto-alert indicator

Advanced electric controls. Front ON-OFF switch routine maintenance alarms and advanced PC board with one touch cleaning and indicator lights simplify maintenance manpower and save time.



Easy front access

Front evaporator.
Self-aligning front panel for easy access to key components.

One touch cleaning

NW ice machines equipped with one-touch cleaning to simplify the cleaning process by easily pressing the cleaning button one time.



NU benefits: EASY to compare

	Easy accessibility	Front ON-OFF switch for easy routine maintenance	Reduced size for easy undercounter installation	Advanced PC board for easy diagnostic	Aergonomic design with disappearing door	Medium and half cube
Scotsman	✓	✓	✓	✓	✓	✓
COMPETITOR	✓	✗	✓	✓	✗	✗
COMPETITOR	✓	✓	✗	✓	✓	✓



NW benefits: EASY to compare

Front facing evaporator for easy accessibility

Outside indicator lights for easy diagnostic

Proximity condenser air filter

Full and half cube

Double stack feasibility

One touch cleaning

Scotsman



COMPETITOR



COMPETITOR



Coffee chains

Convenience stores

QSR and casual dining

Hotel chains and resorts

Fine dining, bar and contract catering



HIGHLY Recommended



HIGHLY Recommended



HIGHLY Recommended



Good Selection



Good Selection

Designed with one goal in mind:
TOTAL CUSTOMER SATISFACTION

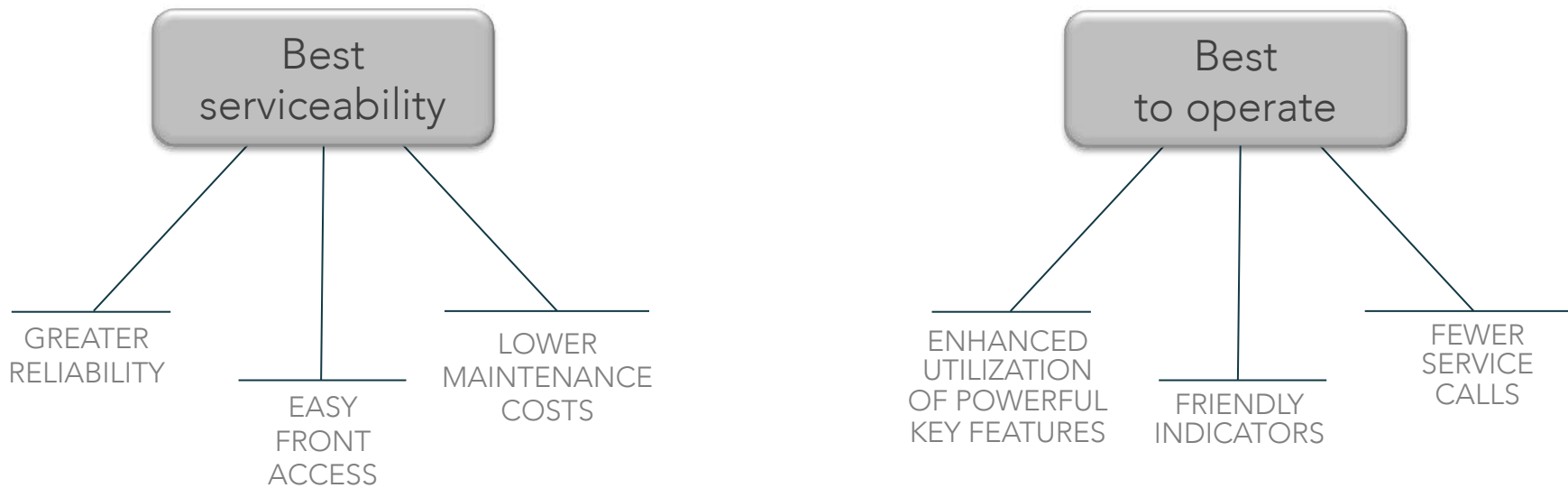

Specifically developed to meet demanding needs from global markets.

Scotsman



Dice ice goes EAS^Y

NU & NW available from November 2015

Scotsman
Ice Systems



THANK YOU!

www.scotsman-ice.it
Scotsman Ice App
available on

